

**ITEM 13. ITEM FOR COMMITTEE INFORMATION – PARKING – SUSSEX  
STREET FROM BATHURST STREET TO GOULBURN STREET  
SYDNEY**

**TRIM RECORD NO: 2015/300568**

**RECOMMENDATION**

It is recommended that the Committee endorse the following:

- (A) Provision of a right turn lane on the western kerbside lane of Sussex Street from James Street to Liverpool Street;
- (B) Provision of a left turn lane on the eastern kerbside lane in Sussex Street from Edgar Lane to Goulburn Street;
- (C) Provision of a right turn lane on the western kerbside lane in Sussex Street from Edgar Lane to Goulburn Street;
- (D) Reallocation of kerbside parking on eastern side of Sussex Street between points 50.2 metres and 89.3 metres, south of the southern building alignment on Liverpool Street to "Loading Zone Ticket 6am-3pm Mon-Fri, 6am-10am Sat", "No Stopping 3pm-8pm Mon-Fri" and "4P Ticket 8pm-12am Mon-Fri, 10am-10pm Sat, 8am-10pm Sun & Public Holidays";
- (E) Reallocation of parking on the eastern side of Sussex Street between Edgar Lane and Goulburn Street to "No Stopping";
- (F) Reallocation of parking on the western side of Sussex Street between points 6.1 metres and 31.2 metres, south of the southern kerb line of James Street to "Loading Zone Ticket 6am-3pm Mon-Fri, 6am-10am Sat", "No Stopping 3pm-8pm Mon-Fri" and "4P Ticket 8pm-12am Mon-Fri, 10am-10pm Sat, 8am-10pm Sun & Public Holidays";
- (G) Reallocation of parking on the western side of Sussex Street between point 31.2 metres south of the southern kerb line of James Street and the northern kerb line of Liverpool Street to "No Stopping";
- (H) Reallocation of parking on the western side of Sussex Street between points 80.6 metres and 98.7 metres, south of the southern building alignment on Liverpool Street to "Loading Zone 6am-3pm Mon-Fri", "No Stopping 3pm-8pm Mon-Fri" and "4P Ticket 8pm-12am Mon-Fri, 10m-10pm Sat, 8am-10pm Sun & Public Holidays";
- (I) Reallocation of parking on the western side of Sussex Street between points 98.7 metres and 106.6 metres, south of the southern building alignment on Liverpool Street to "No Stopping 3pm-8pm Mon-Fri" and "No Parking other times";
- (J) Reallocation of parking on the western side of Sussex Street between points 106.6 metres and 129.6 metres, south of the southern building alignment on Liverpool Street to "Loading Zone Ticket 6am-3pm Mon-Fri, 6am-10am Sat", "No Stopping 3pm-8pm Mon-Fri" and "4P Ticket 8pm-12am Mon-Fri, 10am-10pm Sat, 8am-10pm Sun & Public Holidays"; and
- (K) Reallocation of parking on the western side of Sussex Street between points 129.6 metres and 136.7 metres, south of the southern building alignment on Liverpool Street to "No Stopping".

**DECISION**

The Committee carried the recommendation unanimously out-of-session on 1 October 2015.

## **BACKGROUND**

The Sydney City Centre Capacity Improvement Program (SCCCIP) is a NSW Government initiative to temporarily manage congestion within the Sydney CBD through improved road infrastructure, retaining vehicle capacity and reducing congestion in the City during the construction of the Sydney CBD and South East Light Rail Project (CSELR).

The SCCCIP will be delivered by Roads and Maritime Services (RMS) and includes:

- Modifying and realigning traffic lanes;
- Introducing changes to kerbside uses;
- Temporarily removing kerb extensions;
- Temporarily reducing footpath widths;
- Traffic signal modifications; and
- Modifying or removing some on-street parking.

The proposals set out as part of the SCCCIP will be reviewed six months after implementation to ensure effective operation of the changes. Following commencement of services for the CBD and South-East Light Rail, and following consultation between the City and RMS, any measures reducing pedestrian and cyclist accessibility will be reinstated by RMS at full cost.

## **COMMENTS**

The kerb space on Sussex Street from Bathurst Street to Goulburn Street is generally signposted as Loading Zone, 2P and 4P Ticket.

The proposed parking change seeks support to provide kerb space dedicated to No Stopping, Loading and Ticket Parking.

## **CONSULTATION**

The RMS publically exhibited the Review of Environmental Factors (REF), from 24 November 2014 to 9 January 2015. Notification of the REF included a letterbox drop to 42,000 residents and businesses including about 400 letters to key stakeholders, businesses and residents located adjacent to the various individual proposals.

There were a total of 122 submissions in response to the REF. 104 submissions were opposed to the proposal, nine submissions were in support of the proposal.

The submissions in support of the proposal were in favour of increased vehicle capacity in the CBD. The submissions opposed to the proposal were opposed to the reduction in pedestrian space.

## **FINANCIAL**

Implementation of all works associated with the SCCCIP including any restoration works required following the implementation of the CSELR, will be fully funded by the NSW State Government.

**ATTACHMENTS**

Item for Committee Information – Traffic Treatment – Sussex Street from Bathurst Street and Goulburn Street, Sydney

Stephen Sherwin, Project Manager – Roads and Maritime Services

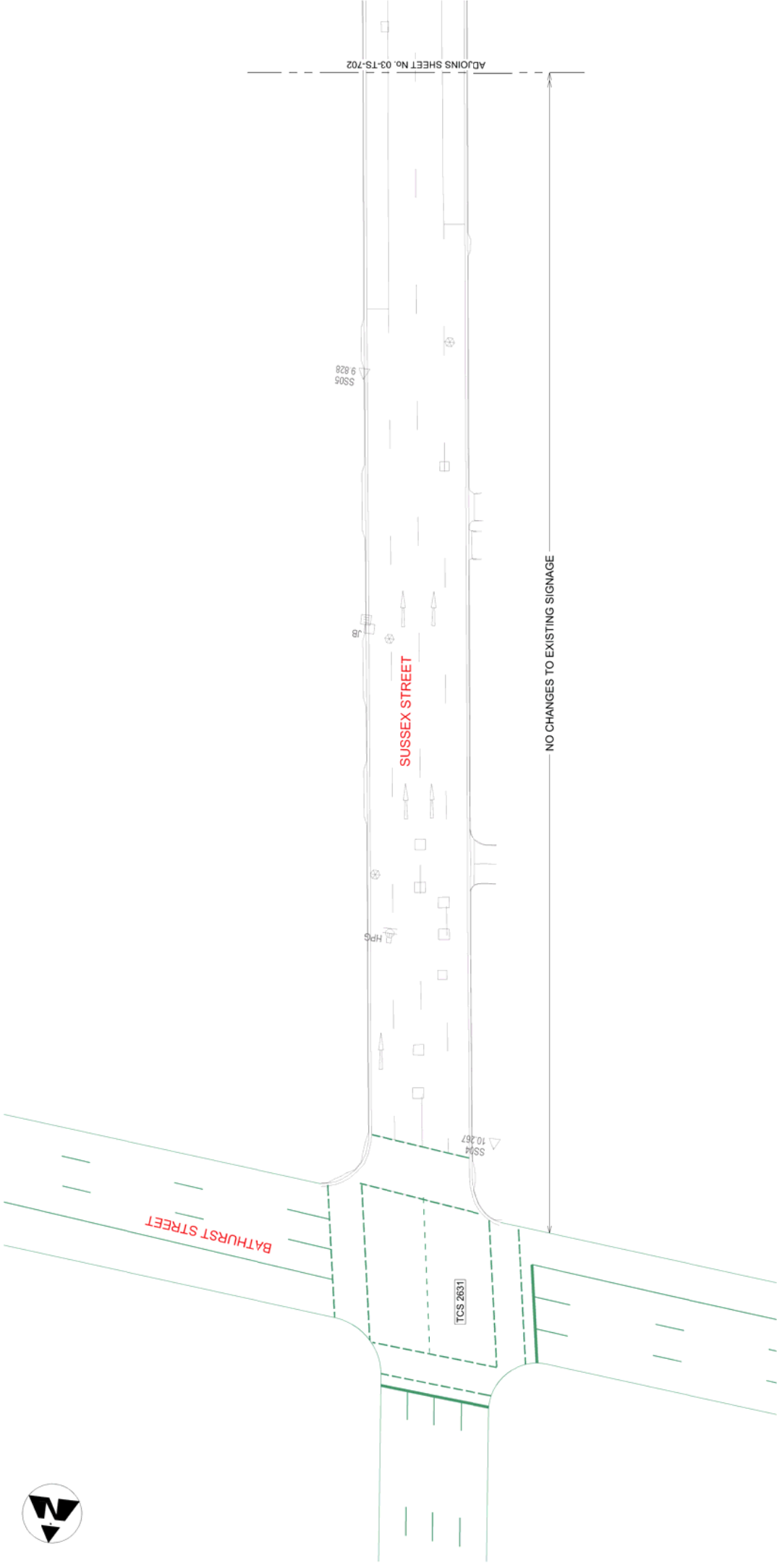

ADJOINS SHEET No. 03-TS-702

NO CHANGES TO EXISTING SIGNAGE

SS05  
9.828

SUSSEX STREET

BATHURST STREET

TCS 2631

HPG

JP

SS04  
10.267

REVISIONS

No.	Description	Date	Drawn	Chkd
A	ISSUED FOR PERMIT	24/01/15	AO	RM
B	ISSUED FOR PERMIT	24/01/15	AO	RM

GENERAL NOTES

1. DO NOT SCALE DRAWINGS. DIMENSIONS HAVE PREFERENCE OVER SCALED DIMENSIONS.
  2. ANY DISCREPANCIES MUST BE REPORTED IMMEDIATELY TO THE SUPERINTENDENT.
  3. ENGINEERING DOCUMENTS MUST BE KEPT IN CONJUNCTION WITH THE DETAIL SPECIFICATION AND DRAWINGS.
  4. LOCATE AND PROTECT ALL UNDERGROUND SERVICES PRIOR TO ANY EXCAVATION. MAKE GOOD ALL DAMAGE TO EXISTING WORKS CAUSED BY THE ACTIVITY OF THESE WORKS.
  5. THESE DRAWINGS ARE TO BE PRINTED IN COLOUR.
- These drawings are the property of the company and are not to be used for any other project without the written consent of the company. The company shall not be held liable for any errors or omissions in the drawings or for any damage caused by the use of these drawings.

Woolacotts

100-110 St Albans Street, Chesham, NSW 2869  
 Phone: (02) 9393 2100  
 Fax: (02) 9393 2101  
 Email: woolacotts@woolacotts.com.au  
 www.woolacotts.com.au



PROJECT  
 SCCPIP  
 PRECINCT 03 - SOUTHERN PRECINCT

CLIENT  
 GBD ALLIANCE



LINEMARKING & SIGNAGE PLAN

SUSSEX STREET  
 SHEET 1 OF 3

DRAWING No.	REV	DRN	CHKD	APPD	DATE
02150022-03-TS-701	B	AO	RW	RM	17/04/15



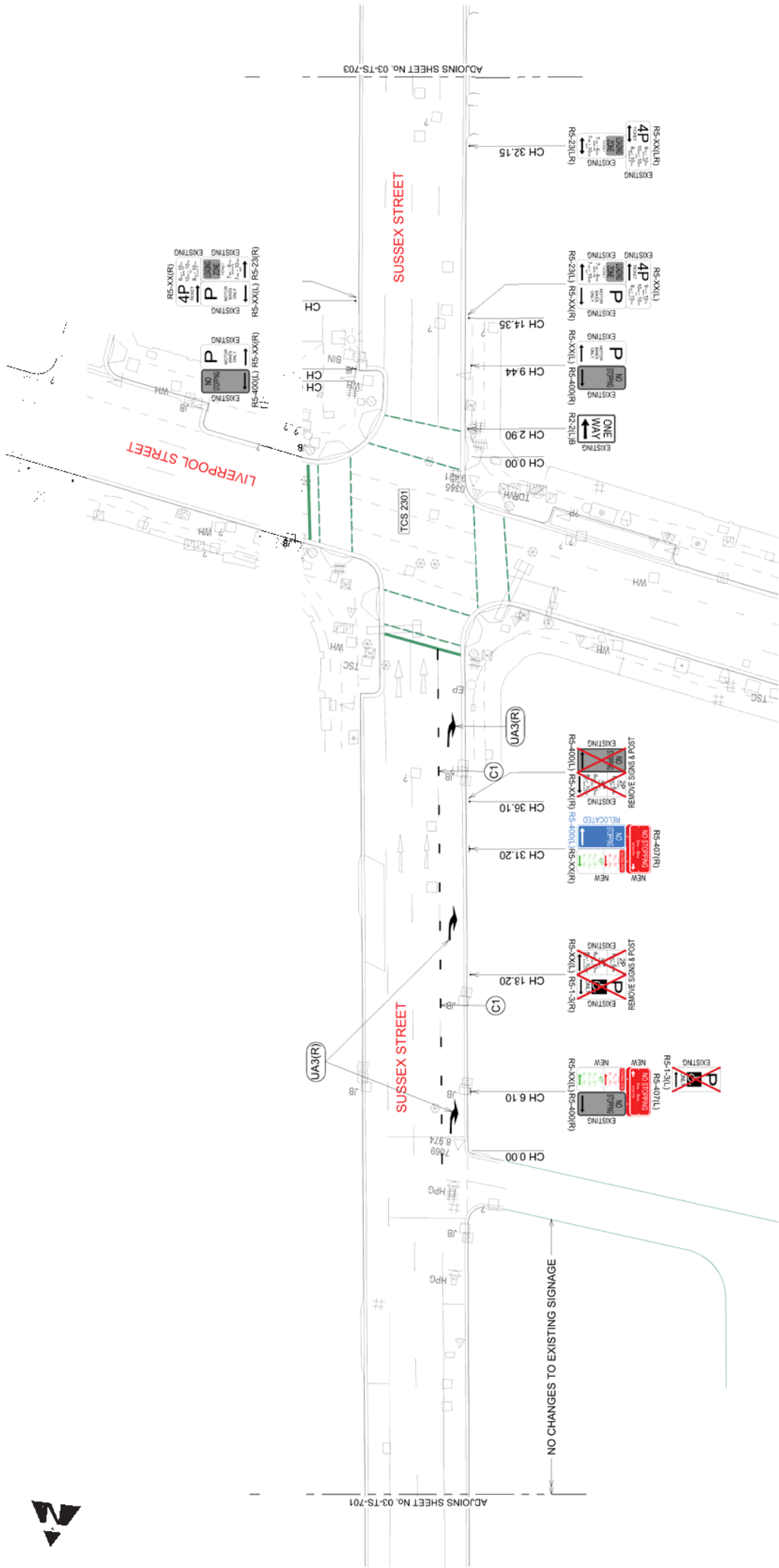

**REVISIONS**

REV	DESCRIPTION	DATE	DESIGN	CHKD	APPRO
A	REVISED SIGNAGE	17/04/15	AO	RW	RM
B	REVISED SIGNAGE	17/04/15	AO	RW	RM

**PROJECT**  
 SCCCP  
 PRECINCT 03 - SOUTHERN PRECINCT  
**CLIENT**  
 GBD ALLIANCE  
**DATE**  
 17/04/15  
**SCALE**  
 1:200 (PLAN)

**LINEMARKING & SIGNAGE PLAN**  
**SUSSEX STREET**  
**SHEET 2 OF 3**  
 DRAWING No. 02150022-03-TS-702  
 REV B AO RW RM

**Lighting, Art & Science**  
 Lighting Consultants, Electrical Engineers  
 9/3 Pacific Highway, PARRAMATTA NSW 2150  
 Ph: (02) 9411 1141 Fax: (02) 9440 1258

**Woolcotts**  
 CONSULTANTS  
 10/15-17/15 Pacific Highway, Parramatta NSW 2150  
 Ph: (02) 9638 1000 Fax: (02) 9638 1001

**WSP**  
 ENGINEERING CONSULTANTS  
 10/15-17/15 Pacific Highway, Parramatta NSW 2150  
 Ph: (02) 9638 1000 Fax: (02) 9638 1001

**PARSONS BRINCKERHOFF**  
 10/15-17/15 Pacific Highway, Parramatta NSW 2150  
 Ph: (02) 9638 1000 Fax: (02) 9638 1001

**GENERAL NOTES**  
 1. DON'T SCALE DRAWINGS - FIGURED DIMENSIONS HAVE PREFERENCE OVER SCALED DIMENSIONS  
 2. ANY DIMENSIONS MUST BE REPORTED IMMEDIATELY TO THE SUPERINTENDENT  
 3. DIMENSIONS MUST BE REPORTED IMMEDIATELY TO THE SUPERINTENDENT  
 4. LOCATE AND PROTECT ALL UNDERGROUND SERVICES PRIOR TO ANY EXCAVATION. MAKE GOOD ALL DAMAGE TO EXISTING WORKS CAUSED BY THE ACTIVITY OF THESE WORKS.  
 5. THESE DRAWINGS ARE TO BE PRINTED IN COLOUR  
 6. THESE DRAWINGS ARE TO BE PRINTED IN COLOUR  
 7. THE CONTRACTOR SHALL BE RESPONSIBLE FOR OBTAINING ALL NECESSARY PERMITS AND APPROVALS FROM THE RELEVANT AUTHORITIES PRIOR TO COMMENCING WORKS.  
 8. THE CONTRACTOR SHALL BE RESPONSIBLE FOR OBTAINING ALL NECESSARY PERMITS AND APPROVALS FROM THE RELEVANT AUTHORITIES PRIOR TO COMMENCING WORKS.  
 9. THE CONTRACTOR SHALL BE RESPONSIBLE FOR OBTAINING ALL NECESSARY PERMITS AND APPROVALS FROM THE RELEVANT AUTHORITIES PRIOR TO COMMENCING WORKS.

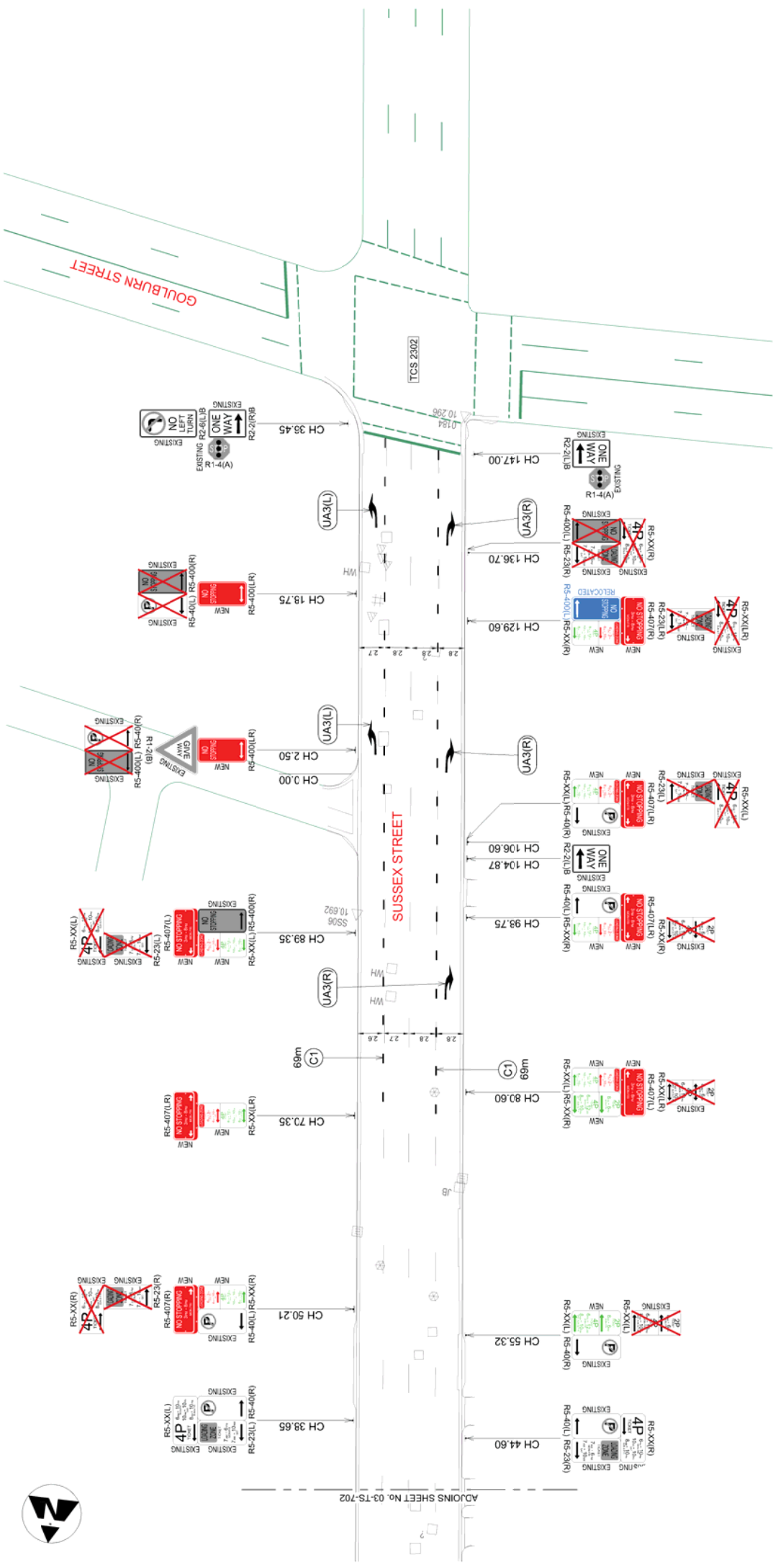

**REVISIONS**

NO.	DESCRIPTION	DATE	DRAWN	CHKD
1	ISSUED FOR CONSTRUCTION	13/03/15	AO	RW
2	ISSUED FOR CONSTRUCTION	13/03/15	AO	RW

**GENERAL NOTES**

1. DO NOT SCALE DIMENSIONS. DIMENSIONS HAVE PREFERENCE OVER SCALED DIMENSIONS.
2. ANY DIMENSIONS MUST BE REPORTED IMMEDIATELY TO THE SUPERINTENDENT.
3. DIMENSIONS DOCUMENTS MUST BE READ IN CONJUNCTION WITH THE DETAIL SPECIFICATIONS AND DIMENSIONS DOCUMENTS.
4. LOCATE AND PROTECT ALL UNDERGROUND SERVICES PRIOR TO ANY EXCAVATION. MAKE GOOD ALL DAMAGE TO EXISTING WORKS CAUSED BY THE ACTIVITY OF THESE WORKS.
5. THESE DRAWINGS ARE TO BE PRINTED IN COLOUR.
6. THESE DRAWINGS ARE THE PROPERTY OF GBD ALLIANCE PTY LTD. ANY UNAUTHORIZED REPRODUCTION OR USE OF THESE DRAWINGS IS STRICTLY PROHIBITED.

**PROJECT**  
 SCCCIP  
 PRECINCT 03 - SOUTHERN PRECINCT  
 CLIENT  
 GBD ALLIANCE

**CONSTRUCTION ISSUE**

**Woolacotts**  
 CONSULTANTS  
 15/16 The Esplanade, Ocean Grove, VIC 3226  
 Phone: (03) 9473 5500  
 Fax: (03) 9473 5501  
 Email: woolacotts@woolacotts.com.au

**WSP**  
 CONSULTANTS  
 15/16 The Esplanade, Ocean Grove, VIC 3226  
 Phone: (03) 9473 5500  
 Fax: (03) 9473 5501  
 Email: woolacotts@woolacotts.com.au

**Lighting, Art & Science**  
 Lighting Consultants, Electrical Engineers  
 15/16 The Esplanade, Ocean Grove, VIC 3226  
 Phone: (03) 9473 5500  
 Fax: (03) 9473 5501  
 Email: woolacotts@woolacotts.com.au

**Landscape Architects  
 Urban Designers  
 Town Planners**  
 Level 8/80 Mount Street North Sydney N.S.W. 2060  
 P. 02 9554 3733  
 www.tract.net.au

**LINEMARKING & SIGNAGE PLAN  
 SUSSEX STREET  
 SHEET 3 OF 3**

DRAWING NO: 02150022-03-TS-703  
 REV. DFN. CHD. APPD.  
 01 AO RW RM  
 DATE: 21/07/15

SCALE: 1:200 (PLAN)